

SALES DRAWING SALES DRAWING

SALES DRAWING SALES DRAWING

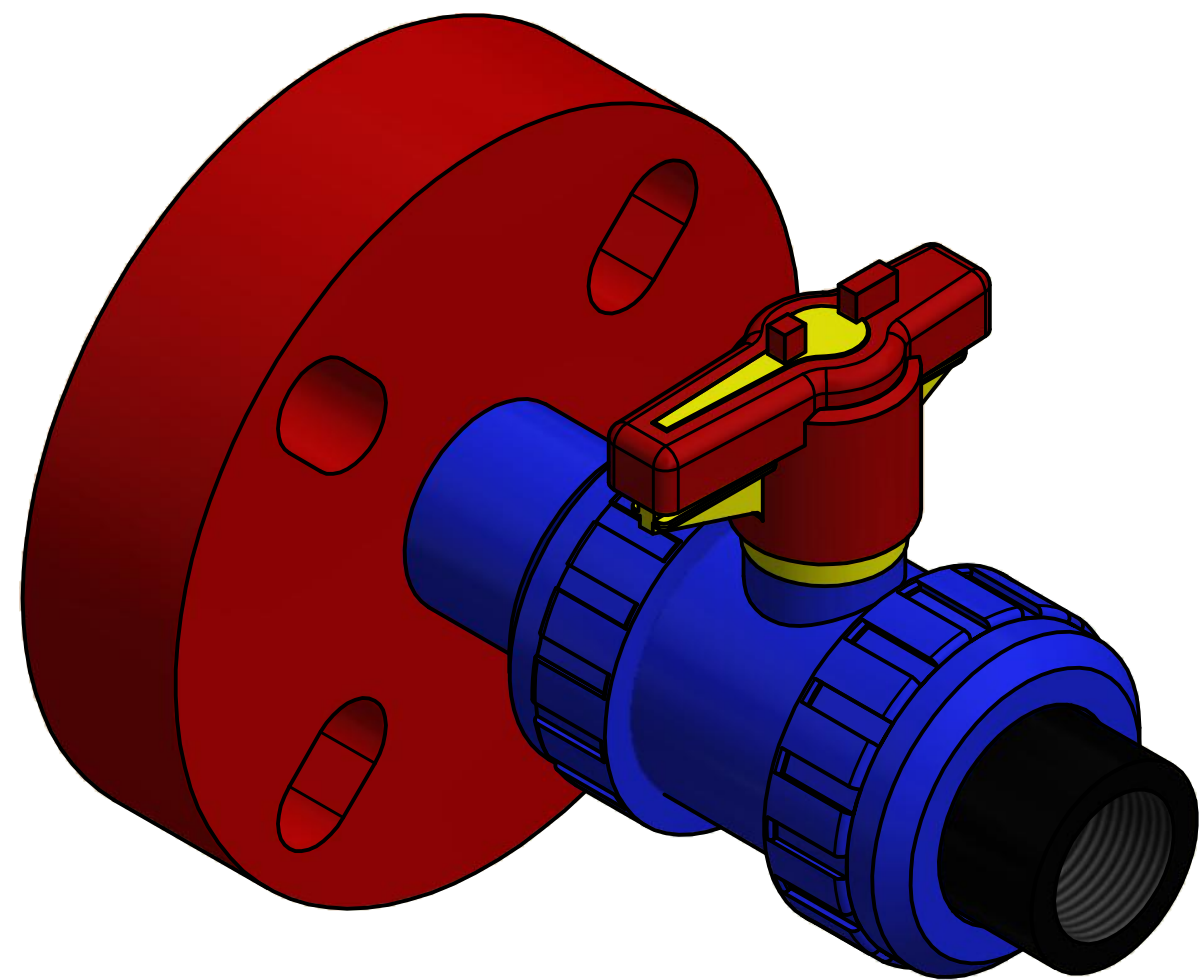
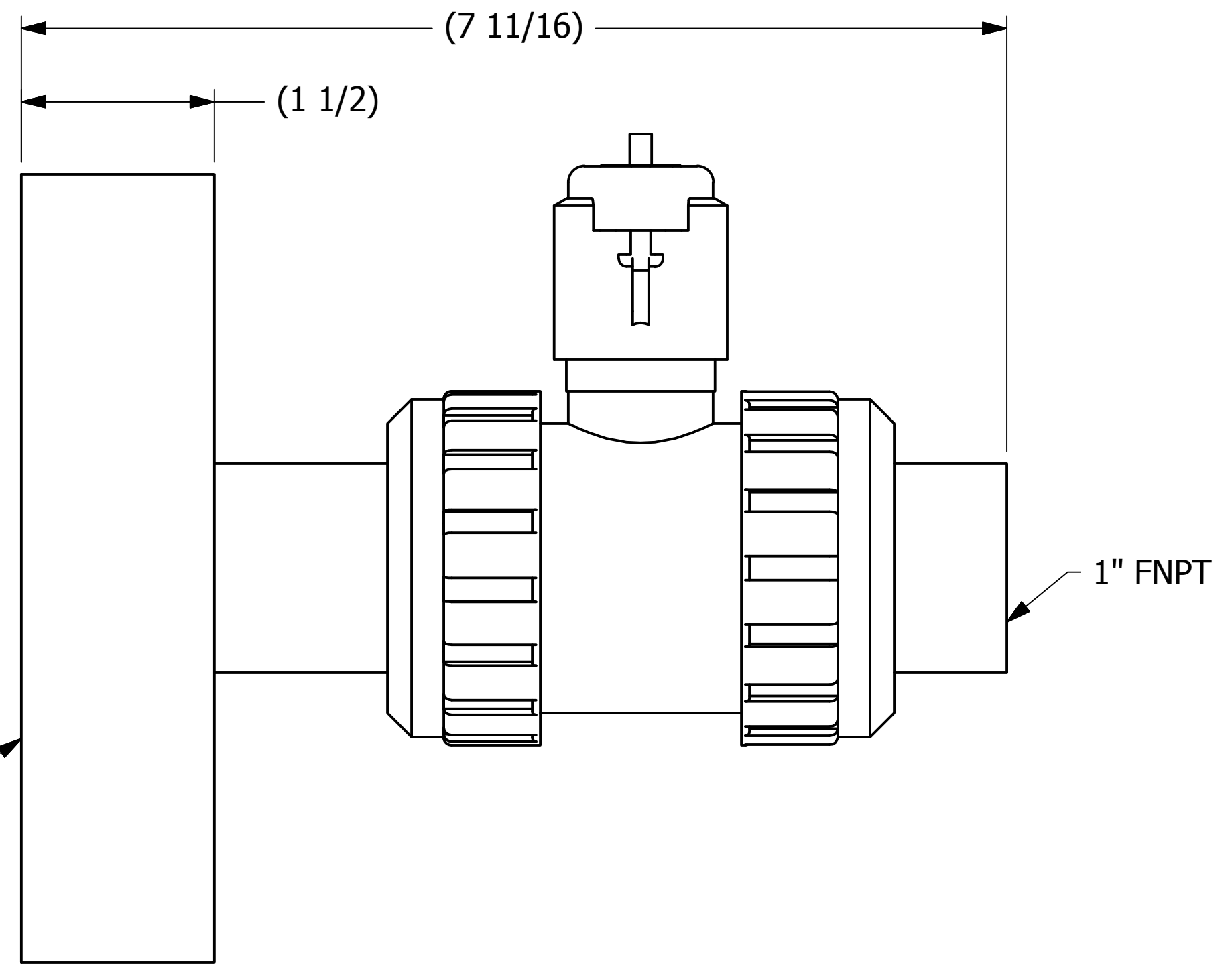
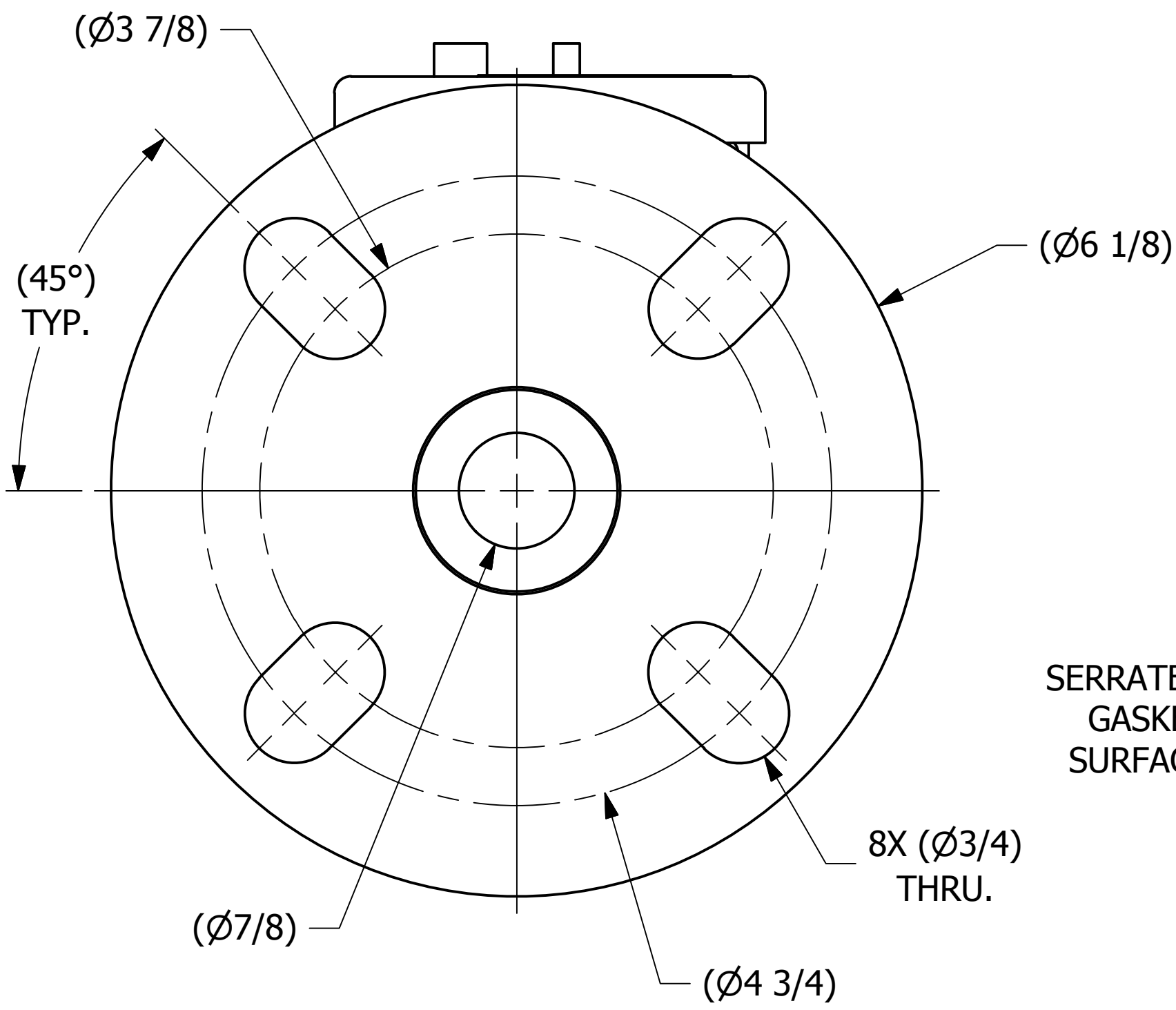

ISOMETRIC VIEW

REV	BY	DATE	DESCRIPTION
B	JG	11-14-18	Q-2.14 WAS QAP5A-1; PART NAME WAS AIR VALVE ASSEMBLY 1 1/2"-1"X1"
A	TAK	10/29/15	RELEASED FOR PRODUCTION

<small>UNLESS OTHERWISE SPECIFIED DIMENSIONAL TOLERANCES FRACTIONAL: <math>\pm 1/16</math> X.XX: <math>\pm .03</math> X.XXX: <math>\pm .015</math> ANGLE: <math>\pm 1^\circ</math> DEBURR ALL SHARP EDGES. ALL MACHINED SURFACES TO HAVE A 125 RMS FINISH UNLESS NOTED OTHERWISE.</small>	DRAWN BY:	JG
	CHECKED BY:	JRO
	PROTOTYPE BY:	JG
	PROTOTYPE DATE:	10/21/2015
	APPROVED FOR PRODUCTION BY:	TAK
THIRD ANGLE PROJECTION	PRODUCTION DATE:	10/29/2015

<b>SALCO PRODUCTS, INC.</b>		
PART NAME: AIR VALVE ASSEMBLY 2 1/2"-1"X1"		
MATERIAL: SALCO PE/PE	PROJECT #: H150908F2	SHEET #: 1 OF 1
DRAWING #: C42559	PART #: HSAVAPE42559	
SCALE: 1:1		

THIS PRINT, PROPERTY OF SALCO PRODUCTS INC., CONTAINS PROPRIETARY INFORMATION AND MUST NOT BE COPIED, REPRODUCED, OR USED DETRIMENTALLY TO OUR INTEREST.